

**vtech**<sup>®</sup>

User's Manual

# Lil' Critters Play & Dream Musical Piano™



© 2014 VTech  
Printed In China  
91-002850-004 (US) (CA)

*Dear Parent,*

*Ever notice the look on your baby's face when they learn something new through their own discovery? These self-accomplished moments are a parent's greatest reward. To help fulfill them, VTech® created the **Infant Learning**® series of toys.*

*These unique interactive learning toys directly respond to what children do naturally – play! Using innovative technology, these toys react to baby's interactions, making each play experience fun and unique as they learn age-appropriate concepts like first words, numbers, shapes, colors and music. More importantly, VTech®'s **Infant Learning**® toys develop baby's mental and physical abilities by inspiring, engaging and teaching.*

*At VTech®, we know that a child has the ability to do great things. That's why all of our electronic learning products are uniquely designed to develop a child's mind and allow them to learn to the best of their ability. We thank you for trusting VTech® with the important job of helping your child learn and grow!*

*Sincerely,*

*Your friends at VTech®*

*To learn more about the **Infant Learning**® series and other VTech® toys, visit [www.vtechkids.com](http://www.vtechkids.com)*

# INTRODUCTION

Thank you for purchasing the **VTECH® Lil' Critters Play & Dream Musical Piano™** learning toy.

Have fun with the **Lil' Critters Play & Dream Musical Piano™**. This soft musical keyboard features five Lil' Critters animals and can be used in or out of the crib. Kick or tap the five piano keys to learn about animals and instruments and hear playful sing-along songs. In the music mode, long playing melodies will help lull baby to sleep.

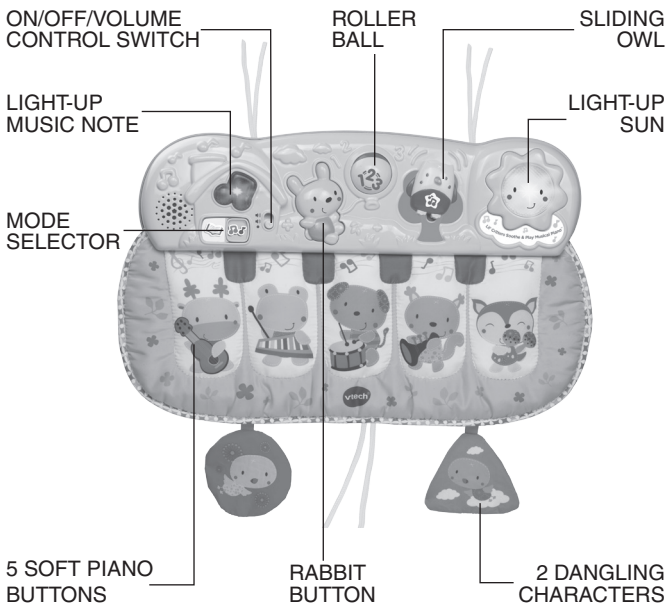

## INCLUDED IN THIS PACKAGE

- One VTech® Lil' Critters Play & Dream Musical Piano™
- One instruction manual

**WARNING:** All packing materials, such as tape, plastic sheets, packaging locks and tags are not part of this toy, and should be discarded for your child's safety.

**ATTENTION:** Pour la sécurité de votre enfant, débarrassez-vous de tous les produits d'emballage tels que rubans adhésifs, feuilles de plastique, attaches et étiquettes. Ils ne font pas partie du jouet.

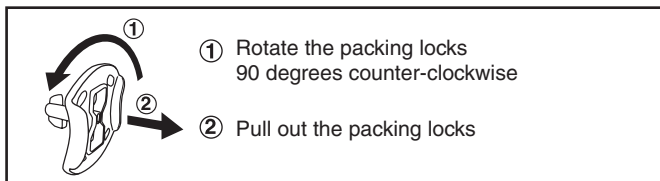

**NOTE:** Please keep this instruction manual as it contains important information.

## GETTING STARTED

### BATTERY INSTALLATION

1. Make sure the unit is turned **OFF**.
2. Locate the battery cover on the bottom of the unit. Use a coin or a screwdriver to loosen the screw.
3. Install 2 new 'AA' (AM-3/LR6) batteries following the diagram inside the battery box. (The use of new alkaline batteries is recommended for maximum performance.)

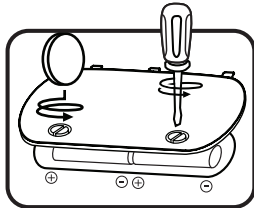

4. Replace the battery cover and tighten the screw to secure.

## **BATTERY NOTICE**

- Use new alkaline batteries for maximum performance.
- Use only batteries of the same or equivalent type as recommended.
- Do not mix different types of batteries: alkaline, standard (carbon-zinc) or rechargeable (Ni-Cd, Ni-MH), or new and used batteries.
- Do not use damaged batteries.
- Insert batteries with the correct polarity.
- Do not short-circuit the battery terminals.
- Remove exhausted batteries from the toy.
- Remove batteries during long periods of non-use.
- Do not dispose of batteries in fire.
- Do not charge non-rechargeable batteries.
- Remove rechargeable batteries from the toy before charging (if removable).
- Rechargeable batteries are only to be charged under adult supervision.

## **IMPORTANT NOTE**

With the **VTech® Lil' Critters Play & Dream Musical Piano™**, safety comes first. To ensure your child's safety, the assembly of this product is an adult activity, not a child's activity. Please ensure that the attachment strap is securely locked into position and the three strings are tied tightly to avoid injury. Please follow the instructions below carefully and make sure the final assembly is correct. Attach only to cribs with sturdy rails and spindles. Do not attach to playpens with mesh walls. Please make sure the crib attachment strap is out of reach from children when placed in the crib.

# ASSEMBLY INSTRUCTIONS

1. Place the unit inside the crib.

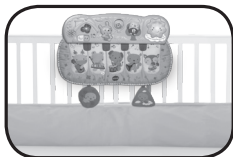

2. Loop the crib attachment strap around the nearest spindle and slide it under the slot on the back of the unit, pulling to secure.

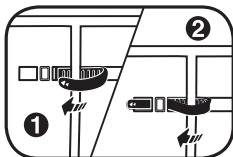

3. Once the crib attachment strap is securely fastened, please tie the three strings to the crib rail and the closest spindle. Pull slightly on the unit to make sure the strap and the three strings have been securely fastened. The unit should be snug against the crib rail. Please check the unit frequently to ensure it is still secure.

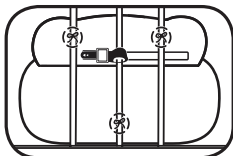
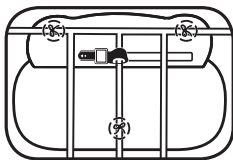

4. To remove the unit from the crib, untie the three strings, then hold down the square button near the crib attachment strap and pull the strap out of the slot.

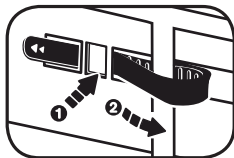

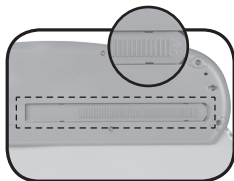

5. When the unit is being used outside of the crib as a floor toy, please make sure the crib attachment strap is clipped into the back of the unit.



## PRODUCT FEATURES

### 1. ON/OFF/VOLUME CONTROL SWITCH

To turn the unit **ON**, slide the **ON/OFF/VOLUME CONTROL SWITCH** to the **LOW VOLUME** (  ) or **HIGH VOLUME** (  ) position. To turn the unit **OFF**, slide the **ON/OFF/VOLUME CONTROL SWITCH** to the **OFF** (  ) position.

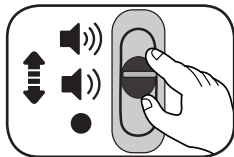

### 2. AUTOMATIC SHUT-OFF

To preserve battery life, the **VTech® Lil' Critters Play & Dream Musical Piano™** will automatically power-down after approximately 24 seconds without input in the learning mode and 8 seconds without input in the music mode. The unit can be turned on again by pressing any button.

## ACTIVITIES

1. Slide the **on/off/volume control switch** to turn the unit on. You will hear a song, a phrase and a short tune. The lights will flash with the sounds.
2. Press the **piano buttons** in the learning mode to hear animal names, instrument names, instrument sounds and songs. In the music mode you will hear piano notes, short tunes or animal sounds. The lights will flash with the sounds.
3. Slide the **owl** or press the **rabbit** to hear fun sounds and playful phrases in the learning mode. In the music mode you will hear music play for 15 minutes. While the melodies are playing, press the piano keys to hear fun sounds play over the melody. Continue pressing the piano keys or press the owl or rabbit buttons to interrupt the melodies. The lights will flash with the sounds.
4. Spin the **roller ball** in the learning mode to hear fun sounds, a phrase or a song. In the music mode you will hear short tunes or fun sounds. The lights will flash with the sounds.

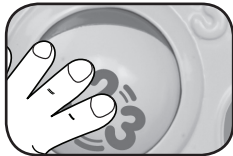
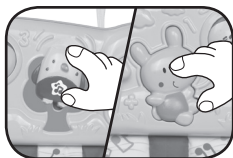
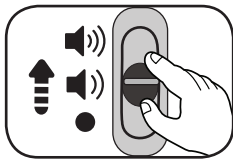



## MELODY LIST:

1. Toyland
2. All Through The Night
3. Are You Sleeping?
4. Good Morning Merry Sunshine
5. Lazy Mary Will You Get Up?
6. Looby Loo
7. Sing a Song of Sixpence
8. Did You Ever See a Lassie?
9. Polly Wolly Doodle
10. Ta-Ra-Ra Boom-De-Ay
11. Teddy Bears' Picnic
12. Turkey in the Straw
13. Aiken Drum
14. White Coral Bells
15. Humpty Dumpty
16. Jack and Jill
17. Twinkle, Twinkle, Little Star
18. Bear Went Over the Mountain
19. Mary, Mary Quite Contrary
20. Yankee Doodle

# SUNG SONG LYRICS

## SONG 1

The animals are playing music in the sun.  
Singing, dancing and playing to the songs!

## SONG 2

Singing with the animals is so much fun!

## SONG 3

Peek-a-boo, little deer,  
Strumming a happy tune on the guitar.

## SONG 4

Ribbit-ribbit, little froggie,  
Tapping on the colourful xylophone.

## SONG 5

Rat-a-tat-tat, little doggie,  
Tapping a song on the drum.

## SONG 6

Toot-toot, little squirrel,  
Playing out loud on the trumpet!

## SONG 6

Rattle-rattle, little fox,  
Shaking the maracas in the air.

## CARE & MAINTENANCE

1. Keep the unit clean by wiping it with a slightly damp cloth.
2. Keep the unit out of direct sunlight and away from any direct heat source.
3. Remove the batteries when the unit will not be in use for an extended period of time.
4. Do not drop the unit on hard surfaces and do not expose the unit to moisture or water.

## TROUBLESHOOTING

If for some reason the program/activity stops working or malfunctions, please follow these steps:

1. Please turn the unit **OFF**.
2. Interrupt the power supply by removing the batteries.
3. Let the unit stand for a few minutes, then replace the batteries.
4. Turn the unit **ON**. The unit should now be ready to play again.
5. If the product still does not work, replace with an entire set of new batteries.

If the problem persists, please call our Consumer Services Department at 1-800-521-2010 in the U.S. or 1-877-352-8697 in Canada, and a service representative will be happy to help you.

For information on this product's warranty, please call our Consumer Services Department at 1-800-521-2010 in the U.S. or 1-877-352-8697 in Canada.

**IMPORTANT NOTE:**

Creating and developing **Infant Learning** products is accompanied by a responsibility that we at **VTech®** take very seriously. We make every effort to ensure the accuracy of the information, which forms the value of our products. However, errors sometimes can occur. It is important for you to know that we stand behind our products and encourage you to call our Consumer Services Department at 1-800-521-2010 in the U.S., or 1-877-352-8697 in Canada, with any problems and/or suggestions that you might have. A service representative will be happy to help you.

**NOTE :**

This equipment has been tested and found to comply with the limits for a Class B digital device, pursuant to Part 15 of the FCC Rules. These limits are designed to provide reasonable protection against harmful interference in a residential installation. This equipment generates, uses and can radiate radio frequency energy and, if not installed and used in accordance with the instructions, may cause harmful interference to radio communications. However, there is no guarantee that interference will not occur in a particular installation. If this equipment does cause harmful interference to radio or television reception, which can be determined by turning the equipment off and on, the user is encouraged to try to correct the interference by one or more of the following measures:

- Reorient or relocate the receiving antenna.
- Increase the separation between the equipment and receiver.
- Connect the equipment into an outlet on a circuit different from that to which the receiver is connected.
- Consult the dealer or an experienced radio/TV technician for help.

THIS DEVICE COMPLIES WITH PART 15 OF THE FCC RULES. OPERATION IS SUBJECT TO THE FOLLOWING TWO CONDITIONS: (1) THIS DEVICE MAY NOT CAUSE HARMFUL INTERFERENCE, AND (2) THIS DEVICE MUST ACCEPT ANY INTERFERENCE RECEIVED, INCLUDING INTERFERENCE THAT MAY CAUSE UNDESIRABLE OPERATION.

CAN ICES-3 (B)/NMB-3(B)

**Caution:** changes or modifications not expressly approved by the party responsible for compliance could void the user's authority to operate the equipment.

